

## Miniature Metal Bellows Coupling – Stainless Steel Version

with Collet Clamp  
Hub : Stainless Steel

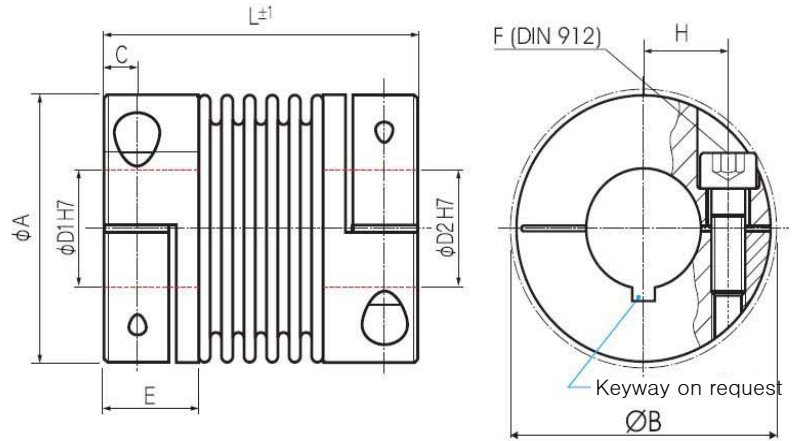

Order Code : **KB2/45 – 50 – 10 – 16 – VA/VAW**

Type / Size

Length L

Ø D1  
H7

Ø D2  
H7

Stainless  
Steel Glued

Stainless Steel  
Welded

VA/VAW	Torque $T_{KN}$ (Nm)	Dimensions ( mm )								Technical Ratings							
		L	Ø A	D1 / D2	H	C	Ø B	E	F	Mass (g)	Moment of Inertia J (g cm <sup>2</sup> )	Spring Stiffness			Misalignment		
		Length (±1)	Outer Ø	Bore Sizes (H7) min~max			Max Ø	Hub- Length	Screw Length (DIN912) $T_A$ (Nm)			torsional $C_T$ (Nm/rad)	radial $C_R$ (N/mm)	axial $C_A$ (N/mm)	radial $\Delta Kr$ (mm)	axial $\Delta Ka$ (mm)	angular $\Delta Kw$ (°)
KB2/1	0.1	25	10	1-4	3.4	2	11	7	M1.6	7	1	65	10	14	0.12	0.2	1.2
		0.1															
KB2/5	0.5	21	15.5	3-7	5.2	2.5	17.5	8	M2	18	5.9	260	43	13	0.1	0.2	1
		0.43							18	6.2	200	18	10	0.15	0.3	1.5	
		0.43							19	6.6	160	9	8	0.2	0.4	2	
KB2/10	1	23	15.5	3-7	5.2	2.5	17.5	8	M2	19	6.8	510	74	27	0.1	0.2	1
		0.43							20	7.5	380	31	20	0.15	0.3	1.5	
		0.43							21	8.1	310	16	16	0.2	0.4	2	
KB2/15	1.5	26	20	3-10	7	3	21	9	M2.5	36	18	750	59	15	0.1	0.3	1.5
		0.85							38	21	700	20	9	0.15	0.4	2	
KB2/20	2	32	25	3-12.7	9	3.5	27	11	M3	70	53	1500	67	12	0.15	0.3	1.5
		0.43							73	60	1300	21	11	0.2	0.4	1.5	
		0.43							75	64	1050	11	9	0.25	0.5	2	
		0.43							92	73	1050	11	9	0.25	0.5	2	
KB2/45	4.5	41	32.5	6-16	12	5	34	14	M4	133	220	6500	168	32	0.1	0.3	1.5
		0.43							166	240	6500	168	32	0.1	0.3	1.5	
		0.43							139	246	4200	41	20	0.2	0.5	2	
		0.43							172	266	4200	41	20	0.2	0.5	2	
KB2/100	10	48	40.5	6-22	15.5	5	41.5	14	M4	244	513	8100	120	27	0.15	0.4	1.5
		0.43							300	600	8100	120	27	0.15	0.4	1.5	
		0.43							261	638	6800	29	17	0.3	0.6	2	
		0.43							317	726	6800	29	17	0.3	0.6	2	

- \* Material : Bellows – Highly elastic Stainless Steel  
Hub – Stainless Steel
- \* Hub : Bore Tolerance : H7 keyway acc. DIN 6885 optional
- \* Version : VA – Stainless Steel Glued  
VAW – Stainless Steel Welded
- \* Temperature Range : VA -30 °C ~ 120 °C (Glued)  
VAW -30 °C ~ 250 °C (Welded)