

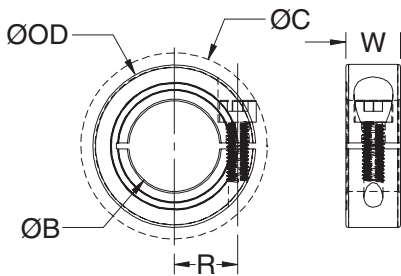

PART NUMBER				SPECIFICATIONS					
BLACK OXIDE STEEL	ALUMINUM	STAINLESS STEEL	PLASTIC	BORE B (mm)	OUTER DIAM. OD (mm)	SCREW LOCATION R (mm)	CLEARANCE DIAMETER C (mm) MAX	WIDTH W (mm)	FORGED CLAMP SCREW
MCL-3-F	MCL-3-A	MCL-3-SS		3	16	5.51	20.8	9	M3
MCL-4-F	MCL-4-A	MCL-4-SS		4	16	5.51	20.8	9	M3
MCL-5-F	MCL-5-A	MCL-5-SS	MCL-5-P	5	16	5.51	20.8	9	M3
MCL-6-F	MCL-6-A	MCL-6-SS	MCL-6-P	6	16	5.51	20.8	9	M3
MCL-7-F	MCL-7-A	MCL-7-SS		7	18	6.50	22.4	9	M3
MCL-8-F	MCL-8-A	MCL-8-SS	MCL-8-P	8	18	6.50	22.4	9	M3
MCL-9-F	MCL-9-A	MCL-9-SS		9	24	8.51	26.3	9	M3
MCL-10-F	MCL-10-A	MCL-10-SS	MCL-10-P	10	24	8.51	26.3	9	M3
MCL-11-F	MCL-11-A	MCL-11-SS		11	28	10.01	32.0	11	M4
MCL-12-F	MCL-12-A	MCL-12-SS	MCL-12-P	12	28	10.01	32.0	11	M4
MCL-13-F	MCL-13-A	MCL-13-SS		13	30	11.00	33.7	11	M4
MCL-14-F	MCL-14-A	MCL-14-SS	MCL-14-P	14	30	11.00	33.7	11	M4
MCL-15-F	MCL-15-A	MCL-15-SS	MCL-15-P	15	34	12.50	39.3	13	M5
MCL-16-F	MCL-16-A	MCL-16-SS	MCL-16-P	16	34	12.50	39.3	13	M5
MCL-17-F	MCL-17-A	MCL-17-SS		17	36	13.49	41.1	13	M5
MCL-18-F	MCL-18-A	MCL-18-SS		18	36	13.49	41.1	13	M5
MCL-19-F	MCL-19-A	MCL-19-SS		19	40	14.73	47.4	15	M6
MCL-20-F	MCL-20-A	MCL-20-SS	MCL-20-P	20	40	14.73	47.4	15	M6
MCL-21-F	MCL-21-A	MCL-21-SS		21	42	16.00	49.5	15	M6
MCL-22-F	MCL-22-A	MCL-22-SS		22	42	16.00	49.5	15	M6
MCL-23-F	MCL-23-A	MCL-23-SS		23	45	17.50	52.1	15	M6
MCL-24-F	MCL-24-A	MCL-24-SS		24	45	17.50	52.1	15	M6
MCL-25-F	MCL-25-A	MCL-25-SS	MCL-25-P	25	45	17.50	52.1	15	M6
MCL-26-F	MCL-26-A	MCL-26-SS		26	48	19.00	54.7	15	M6
MCL-28-F	MCL-28-A	MCL-28-SS		28	48	19.00	54.7	15	M6
MCL-30-F	MCL-30-A	MCL-30-SS	MCL-30-P	30	54	21.49	59.2	15	M6
MCL-32-F	MCL-32-A	MCL-32-SS		32	54	21.49	59.2	15	M6
MCL-34-F	MCL-34-A	MCL-34-SS		34	57	23.24	62.4	15	M6
MCL-35-F	MCL-35-A	MCL-35-SS		35	57	23.24	62.4	15	M6
MCL-36-F	MCL-36-A	MCL-36-SS		36	57	23.24	62.4	15	M6
MCL-38-F	MCL-38-A	MCL-38-SS		38	60	24.99	65.6	15	M6
MCL-40-F	MCL-40-A	MCL-40-SS		40	60	24.99	65.6	15	M6
MCL-42-F	MCL-42-A	MCL-42-SS		42	73	29.49	80.1	19	M8
MCL-45-F	MCL-45-A	MCL-45-SS		45	73	29.49	80.1	19	M8
MCL-48-F	MCL-48-A	MCL-48-SS		48	78	32.00	84.7	19	M8
MCL-50-F	MCL-50-A	MCL-50-SS		50	78	32.00	84.7	19	M8
MCL-54-F		MCL-54-SS		54	82	34.24	88.8	19	M8
MCL-55-F		MCL-55-SS		55	82	34.24	88.8	19	M8
MCL-60-F		MCL-60-SS		60	88	37.01	94.0	19	M8
MCL-65-F		MCL-65-SS		65	93	39.50	99.8	19	M8
MCL-70-F		MCL-70-SS		70	98	42.01	104.5	19	M8
MCL-75-F		MCL-75-SS		75	103	44.50	109.1	19	M8
MCL-80-F		MCL-80-SS		80	108	46.99	113.8	19	M8

Note: Sizes MCL-40 through MCL-80 do not have backslot.



- Does not mar the shaft.
- Single point faced.
- Inch sizes on page 4.
- Balanced versions available.
- Width tolerance: +.08 mm
-.25 mm